

[This document consists of 2 pages.]

[Part No: MBLED-001]

Terms and Conditions:*

RETURN POLICY: Requests for returns must be made within 15 days of date of delivery. Please inspect the order upon arrival and notify MOTORCYCLEMODS LLC immediately about missing or damaged parts. Damaged parts must be returned to receive a replacement. If returning for a refund, ordered items must be in unused condition, without evidence of trial fitment, or any other modification. Return requests must be in writing. Email requests to sales@motorcyclemods.com

WARRANTY AND LIMITATION OF LIABILITY: MOTORCYCLEMODS LLC EXPRESSLY DISCLAIMS ALL EXPRESS OR IMPLIED WARRANTIES, INCLUDING THE WARRANTY OF MERCHANTABILITY AND FITNESS FOR A PARTICULAR PURPOSE. MOTORCYCLEMODS LLC's and its member/s' liability for any claim arising from or relating to the Goods is limited to the purchaser price of the Goods (contents of the package), provided Purchaser returned the Goods or the repair or replacement of the Goods or parts thereof at the election of MOTORCYCLEMODS LLC. In no event shall MOTORCYCLEMODS LLC or its member/s be liable for any direct, indirect, punitive, incidental, special, consequential damages, or any damages whatsoever arising out of or connected with the use or misuse of this Product. MOTORCYCLEMODS LLC or its member/s shall not have any obligation with respect to the Product or any part thereof, whether based on contract, tort, and strict liability or otherwise. BUYER and end-user ASSUMES ALL RISK AND LIABILITY FROM USE OF PRODUCT.

General Notice: The taillight modification bracket and taillight are provided for use purely as an aesthetic appearance show-purpose alternative to Original Equipment taillight as factory-installed with the vehicle. Use of this bracket is not intended to improve factory installed equipment performance, and in certain unforeseen circumstances, may possibly degrade performance.

[*Terms and Conditions subject to change without notice.]

REFERENCE INSTRUCTIONS FOR TAILLIGHT BRACKET MODIFICATION, FOR HONDA SHADOW SPIRIT VT750DC

Please read through the entire reference instructions and Terms and Conditions before proceeding with the installation.

Parts included:

- main bracket – remove protective film; residue, if any may be removed w/ solvent
- cat eye taillight – version ordered
- fasteners: (2) ¼" x ½" bolts, nuts, (4) washers for main bracket
- (2) small washers for mounting taillight to main bracket

Rear fender assembly:

- remove seat – two bolts on side
- remove seat holding metal bracket (7,22)
- disconnect rear wiring harness from wiring cluster above battery; these include rear turn signal and rear brakelight wires – NOTE WIRING COLOR CODE: **DO NOT SWAP SIDES ON RE-INSTALL !!**
- remove 2 bolts on each side of rear fender strut (9,16); this will loosen the rear fender entirely
- lift off the rear fender assembly carefully, making sure not to scratch paint !
- remove seat nut (17), and carefully separate fender (12) from metal frame (13)

Brake light removal:

[make careful note of wiring routing path in fender frame]

- remove wiring harness from clips; clip edges tend to be sharp; use caution.
- remove stock metal taillight bracket (10)

[contd. on back]

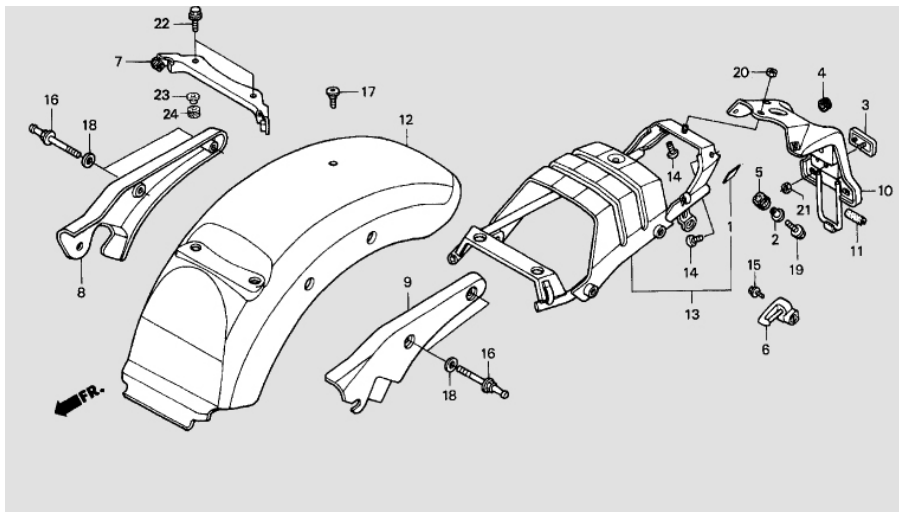

New Bracket installation:

- install new license plate (and frame, if any) **BEFORE** installing taillight on bracket
- pass wires on the wide cateye taillight through main bracket, and fasten taillight on the bracket using two bolts on the light; make sure to install the light so that clear window faces downward, toward lic. plate
- install new bracket over metal fender frame matching the mounting holes; loosely and tighten bolts evenly.
- re-install wires through clips in fender frame; make sure wiring is properly routed, to avoid interference with rear wheel, fender bolts, etc.; leave slight (no more than 0.75") slack where wires exit the taillight housing, to avoid stress on the wires.
- re-install fender assembly; used specified Torque values (47 ft. lb; per service manual)
- reconnect rear turn signal wires (brakelight connection – see below), **AS PER ORIGINAL COLOR CODE: DO NOT SWAP SIDES AS THE WRONG SIDE TURN SIGNAL MAY BE ACTIVATED**

Brakelight Wiring Key: (for taillights with 36" wires ONLY)

- Black wire on taillight to green wire [-ve ground]
- Yellow wire on taillight to Brown wire [running lamp circuit]
- Red wire on taillight to Green/Yellow striped wire [brake circuit]
- Turn switch on; test brake light function before riding, while bike is stationary; if brake light remains ON (bright) and dims when brakes are applied, swap red and yellow wire connections; check again for correct brakelight function.

Important Note: Adjust rear shock setting for proper rider/pillion weight. Shocks set at lowest or excessively soft setting will result in bottoming, and may touch and damage the taillight bracket and/or light. Read Terms and Conditions.

www.motorcyclemods.com
sales@motorcyclemods.com

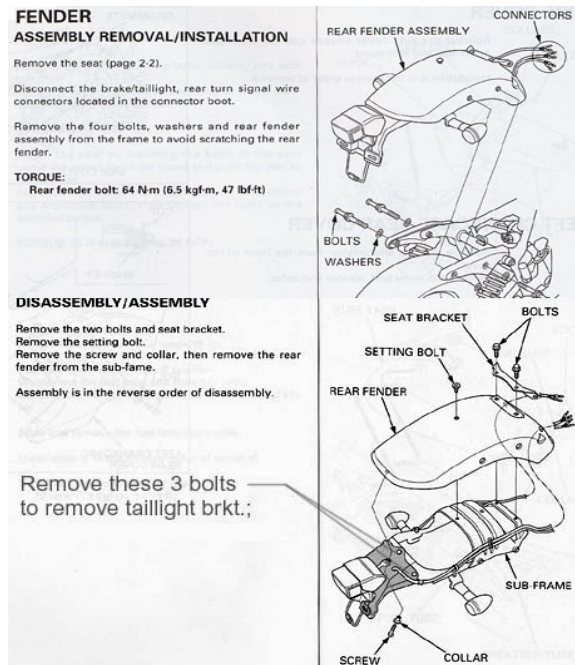

Troubleshooting, if blowing fuses after installation:

- Perform a taillight only connection check, prior to re-installing the complete assembly back on the fender rails. If fuses short, check the bulb housing, to make sure the running and ground leads aren't touching.

- make sure wires aren't snagged or pinched, and are clear of the fender mounting bolts.

And finally, always perform a pre-ride check as outlined in your Owners' Manual ! Ride Safe.

Comments ? Email us at sales@motorcyclemods.com with your thoughts, suggestions.

SPECIAL HANDLING INSTRUCTIONS:

LED CIRCUIT BOARD WIRES ARE FRAGILE; DO NOT PULL THE WIRES; DO NOT HANDLE THE TAILLIGHT WITH WIRES

- TAILLIGHT HOUSING MOUNTING BOLTS MAY BECOME UNSEATED DURING TRANSIT; DO NOT PLUG-IN THE TAILLIGHT TO A POWER SOURCE UNTIL TAILLIGHT IS PROPERLY INSTALLED ON THE BRACKET; FAILURE TO DO SO MAY RESULT IN A SHORT-CIRCUIT, AS MOUNTING BOLTS MAY TOUCH THE CIRCUIT BOARD, IF NOT PROPERLY SEATED; THIS MAY RESULT IN A DAMAGED TAILLIGHT UNIT.
- MAIN BRACKET EDGES MAY BE KEEN; USE CAUTION WHILE HANDLING; HANDGLOVES RECOMMENDED; PROTECTIVE FILM ON TOP PART OF THE BRACKET MAY BE LEFT ON.
- PARTS MAY HAVE SUPERFICIAL SURFACE MARKS IN AREAS NOT VISIBLE AFTER FINAL INSTALLATION.

Copyright © 2008. Motorcyclemods LLC. All Rights Reserved